

Settlement at Lost Creek

City of Sheboygan

- ◆ Large City Lots up to .6 acre
- ◆ Wide frontages for 3 car home designs
- ◆ Paved curb, gutter and roads included
- ◆ City sewer, water and storm

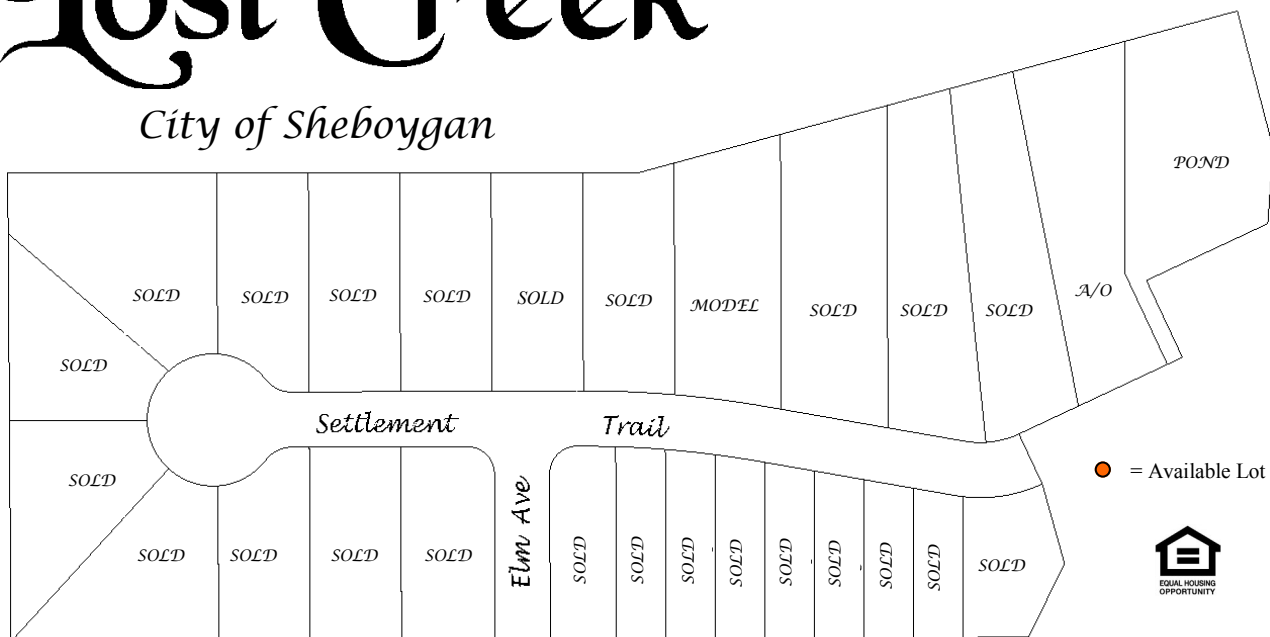

- ◆ 5/12 Roof pitch minimum
- ◆ 5' side yard setback (10' total)
- ◆ All subject to buyer entering into an acceptable building contract with Werner Homes prior to closing on lot
- ◆ City Park Impact Fee is by Buyer (2017- \$547)
- ◆ See condition report regarding fill and possible deeper stoops & garage foundation
- ◆ All sales subject to prior offer and all prices subject to change

Lots	Acres	Price
12	.31	SOLD
13	.41	SOLD
14	.39	SOLD
21	.38	SOLD
22	.51	SOLD
26	.57	A/O

Come Visit Our Product Showroom Filled with Ideas !



- See our LARGE SELECTION of pre-priced ranch and two-story designs
- FURNISHED MODELS Available for TOUR
- Unique Trade-in Program of Current Home

Discover your Possibilities with Werner Homes



WERNER HOMES

Sheboygan County's Largest Home Builder

SHOWROOM LOCATION
4539 South Taylor, Sheboygan
920-458-4104 WernerHomes.com

