

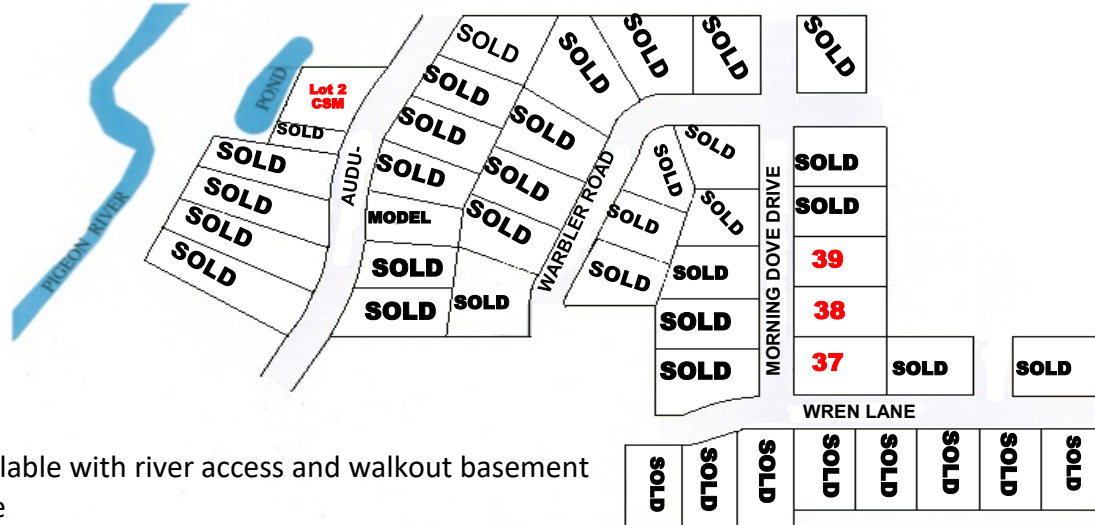

Pigeon River Meadows Subdivision

Village of Howards Grove



- Lots available with river access and walkout basement exposure
- Lots are fully improved with:
 - Paved roadway with curb & gutter
 - Sewer lateral to lot line
 - Gas and Electric to lot line
- Buyer to provide:
 - Well
 - Sewer Connection Fee \$ 1,500
 - Park Fee \$ 850
- Subdivision covenants and restrictions apply
- Lot #37 zoned for single family or two-family/duplex
- All builders are welcome
- All sales subject to availability and prices subject to change

LOT	Acres	Price	MLS #
LOT 2* CSM	.34	\$59,900	1553625
11	.23	MODEL	1553616
37	.39	\$52,900	1553627
38	.33	\$45,900	1553617
39	.33	\$45,900	1553618



A/O—Accepted Offer
 * Walkout Basement Exposure



COLDWELL BANKER
WERNER & ASSOCIATES

4539 South Taylor Drive, Sheboygan, WI
 WWW.COLDWELLBANKER.COM
 (920)458-4103