

# Settlement at Lost Creek

- ◆ Large City Lots up to .6 acre
- ◆ Wide frontages for 3 car home designs
- ◆ Paved curb, gutter and roads included
- ◆ City sewer, water and storm

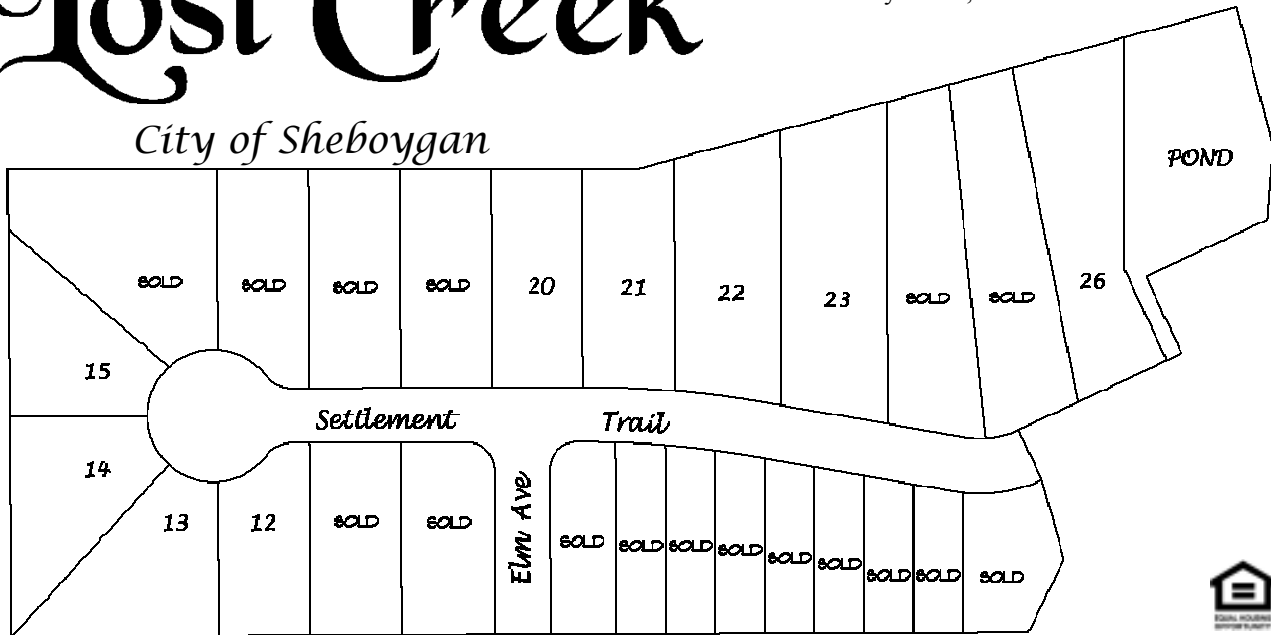

- ◆ 5/12 Roof pitch minimum
- ◆ 25' front yard setback (20' Lot 23)  
5' side yard setback (10' total)
- ◆ \$500 City Sewer Connection Fee
- ◆ All subject to buyer entering into an acceptable building contract with Werner Homes prior to closing on lot
- ◆ See condition report regarding fill and possible deeper stoops & garage foundation
- ◆ All sales subject to prior offer and all prices subject to change

LOT	ACRES	PRICE	LOT	ACRES	PRICE
12	.31	\$37,900	21	.38	\$39,900
13	.41	\$39,900	22	.51	\$40,900
14	.39	\$39,900	23	.60	\$40,900
15	.34	\$39,900	26	.57	\$38,900
20	.38	\$39,900			

A/O = Accepted Offer



Discover your  
Possibilities with  
Werner Homes

## Come Visit Our Product Showroom Filled with Ideas!

- NEW HOMES, Additions and Finished Basements
- See our LARGE SELECTION of pre-priced ranch and two-story designs
- FURNISHED MODELS Available for TOUR
- CHOICE LOTS Available Throughout Sheboygan County
- Unique Trade-in Program of Current Home

### SHOWROOM LOCATION

4539 South Taylor Drive, Sheboygan

(920) 458-4104

Website: [wernerhomes.com](http://wernerhomes.com)

**WERNER  
HOMES**

Sheboygan County's Largest Home Builder